

REV.	ECN	BY	CHKD	REVISION
B	PRE-RLSE	DJZ 8/25/99	BLA 8/25/99	ADDED 80950-15; 13942-01 WAS 80609-15
C	PRE-RLSE	BLH 10/20/99	DJZ 10/20/99	2X Ø.234 WAS Ø.234
D	PRE-RLSE	DJZ 10/20/99	DJZ 10/20/99	.130 WAS .130±.004; .880 WAS .880±.004
0	RLSE	DJZ 3/22/00	GCL 3/22/00	RELEASED

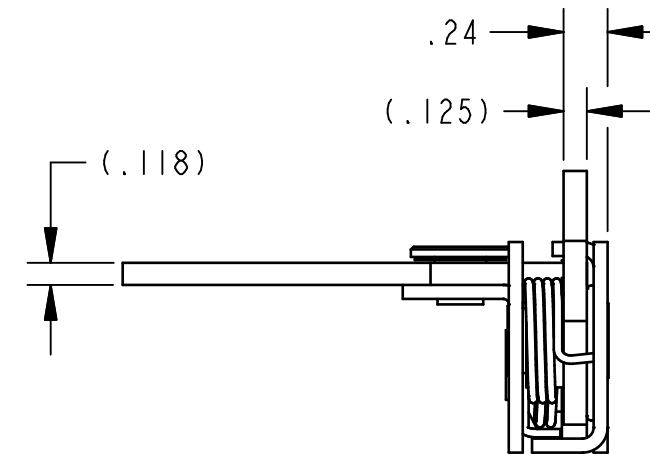
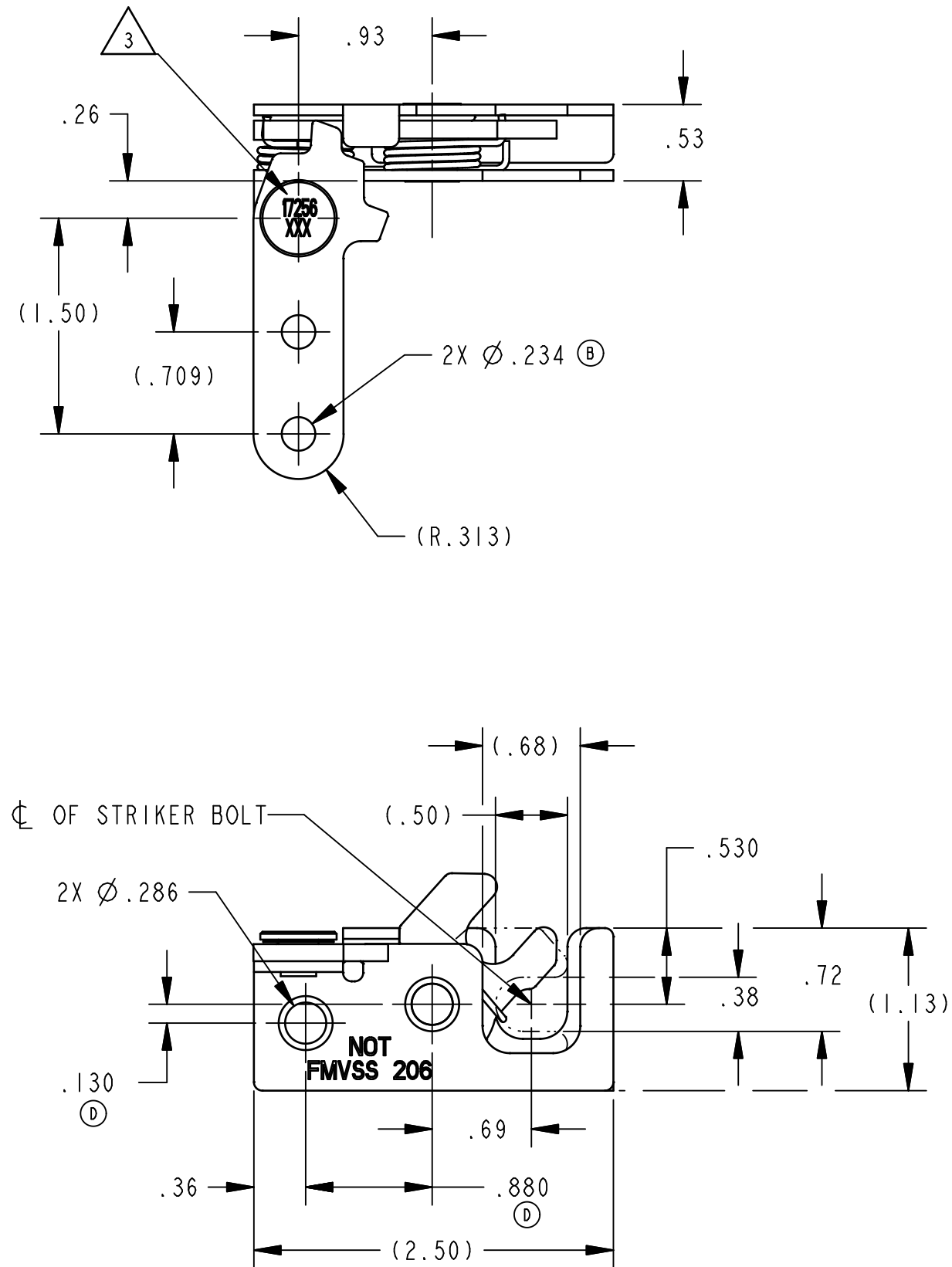

PRODUCT SUPPORT DRAWING
Individual part dimensions are for reference only. Refer to individual part drawings for complete dimensions and specifications.

NOTES:

1. THIS LATCH DOES NOT COMPLY WITH FMVSS 206 REQUIREMENTS.
2. TRIP LEVER POSITIONS (DEGREES COUNTERCLOCKWISE FROM RETURN POSITION AS SHOWN IN THE TOP VIEW): 5° CONTACT, 15° RELEASE, AND 20° MAXIMUM TRAVEL.
3. ASSEMBLY IDENTIFIED WITH PART NUMBER AND DATE CODE APPROXIMATELY AS SHOWN OR IN OTHER APPROVED LOCATIONS AS OUTLINED IN ES-121. ORIENTATION OF THE RIVET CONTAINING PART NUMBER AND DATE CODE NOT IMPORTANT.
4. USE WITH Ø.375 STRIKER BOLT.

SPEC	DESCRIPTION	ITEM	PART NO.	DESCRIPTION	QTY.
DRAWN BY	DJZ	7/22/99	MATL		
CHECKED BY	BLA	7/22/99			
DESIGN ENG.	BLA	3/22/00			
MFG. ENG.			HEAT TREAT		
QUALITY ENG.					
TOLERANCES UNLESS OTHERWISE SPECIFIED ANS1 Y14.5M-1982 DIMENSIONS ANGLES X.X ±.1 X° ±3° X.XX ±.03 X.X° ±1.0° X.XXX ±.010 X.XX° ±.50°			FINISH		
INCH [METRIC]			PROJECT	98091	CUSTOMER PART NO.
FORM 163-210 REV. 1.0 10/15/93			SIZE	C	PROD CODE E31 (050-0500)
			PART WT.		SCALE FULL
			SURFACE AREA		REV. 0
			REPORT ERRORS TO ENGINEERING DEPT.	DO NOT SCALE DRAWING	PART NO. PRI7256
TRI/MARK AN EMPLOYEE-OWNED CORPORATION Industrial Park New Hampton, Iowa 50659 Telephone: 515-394-3188 Fax: 515-394-2392					
THIS DRAWING AND THE INFORMATION CONTAINED HEREIN IS THE PROPERTY OF TRI/MARK CORP. AND SHALL NOT BE USED FOR ANY PURPOSE WITHOUT OUR WRITTEN CONSENT.					
PART NAME 050-0500, LH, I POSN, .286, STR, 2PT					