

NOTES:

- ASSEMBLY IDENTIFIED WITH PART NUMBER AND DATE CODE, APPROXIMATELY AS SHOWN, OR IN OTHER APPROVED LOCATIONS AS OUTLINED IN ES-121. ORIENTATION OF THE RIVET CONTAINING PART NUMBER AND DATE CODE NOT IMPORTANT.
- ASSEMBLY COMPLIES WITH STRENGTH REQUIREMENTS OF SAE STANDARD J839.
- TIGHTEN MOUNTING FASTENERS TO THE FASTENER MANUFACTURER'S RECOMMENDED TORQUE VALUE; HOWEVER, DO NOT EXCEED 120 IN-LBS [13.6N-m].
- WHEN MOUNTING LATCH, MOUNTING HOLE SIZE NOT TO EXCEED ϕ .312 [7.92].
- DIMENSIONS IN [] ARE IN MILLIMETERS FOR REFERENCE ONLY.
- USE WITH TRIMARK'S ϕ .675 [17.15] STRIKER BOLT.
- CONTACT TO RELEASE POSITION APPROXIMATELY 5.0°.
- CONTACT TO MAX TRAVEL APPROXIMATELY 8.8°.
- CONTACT TO FREE TRAVEL APPROXIMATELY 12.8°.

LOCATION OF STRIKER BOLT FOR CUSTOMER REFERENCE.

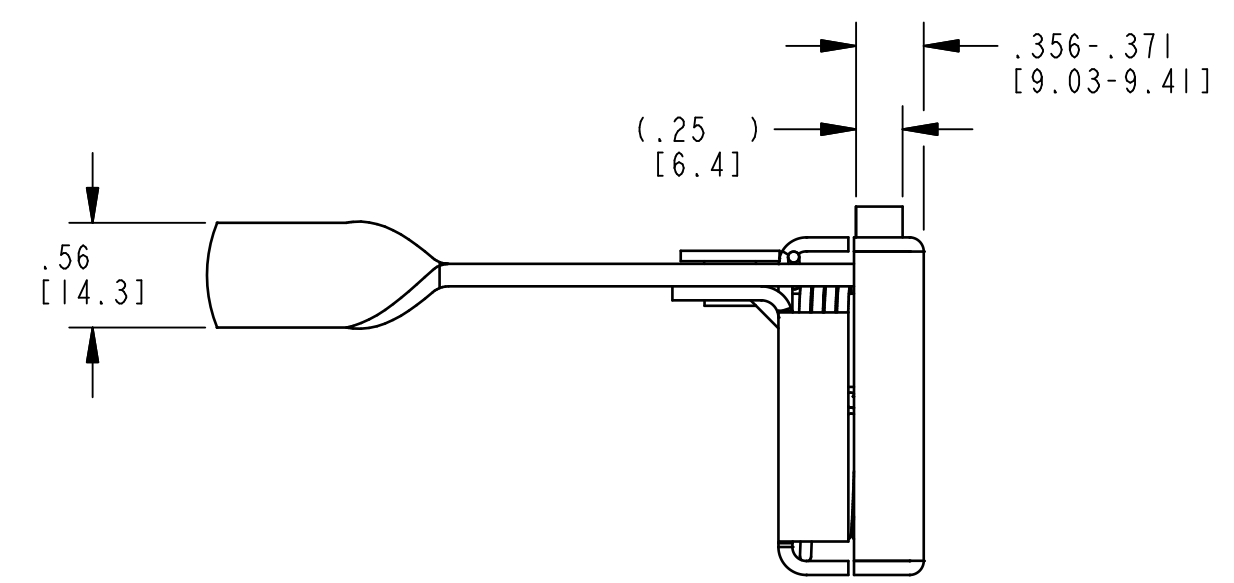
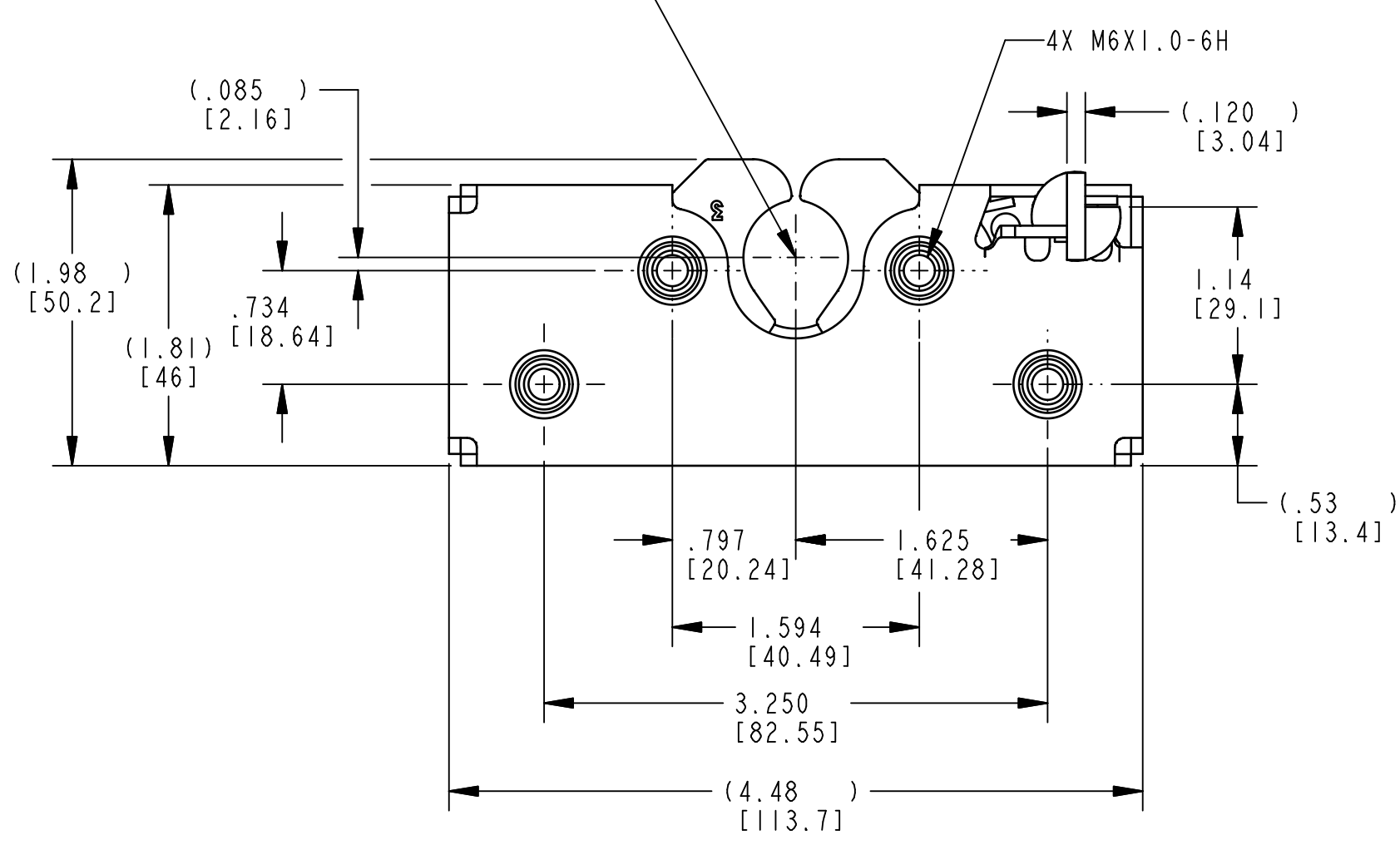

PRODUCT SUPPORT DRAWING
 Individual part dimensions are for reference only. Refer to individual part drawings for complete dimensions and specifications.

SPECIFICATION		DESCRIPTION	ITEM	PART NUMBER	DESCRIPTION	QUANTITY
DRAWN BY	MLH	4/25/02	MATERIAL			
CHECKED BY	JRS	4/25/02	HEAT TREAT			
DESIGN ENG.	GCL		FINISH			
MFG. ENG.			PROJECT	CUSTOMER	CUSTOMER PART NUMBER	
QUALITY ENG.			SIZE	PART WEIGHT	SURFACE AREA	PRODUCT CODE
TOLERANCES UNLESS OTHERWISE SPECIFIED ASME Y14.5M-1994 DIMENSIONS ANGLES X.X ±.1 X° ±3° X.XX ±.03 X.X° ±1.0° X.XXX ±.010 X.XX° ±.50°			REPORT ERRORS TO ENGINEERING DEPARTMENT		DO NOT SCALE DRAWING	
500 Bailey Avenue New Hampton, Iowa 50659 U.S.A. Tel: 641-394-3188 Fax: 641-394-2392						
This drawing and the information contained herein is the property of TriMark Corporation and shall not be used for any purpose without our written consent.						
PART NAME DBLRTR RH 6MM FINGREL						
SCALE	REVISION	PART NUMBER				
FULL	A	PR12180				