

REVISION	ECO	BY	CHECKED	DESCRIPTION
-	-	CRZ 11/12/93	TMG 11/15/93	REDRAWN ON CAD
3	8581	KPE 2/20/95	CRZ 2/20/95	REVISED MODEL
4	8625	DGI 4/10/95	CHS 4/10/95	DELETED NOTE 4
5	9143	BB 1/31/96	DGI 2/1/96	MOVED PRODUCT CODE FROM CUSTOMER PART NO. AREA TO PRODUCT CODE AREA
6	10730	TJZ 11/6/98	BJP 11/6/98	Ø.500±.010 WAS Ø.480-.520
7	18509	MLH 1/31/01	BJE 1/31/01	ADDED VERSION -00; PROD CODES TO BOM

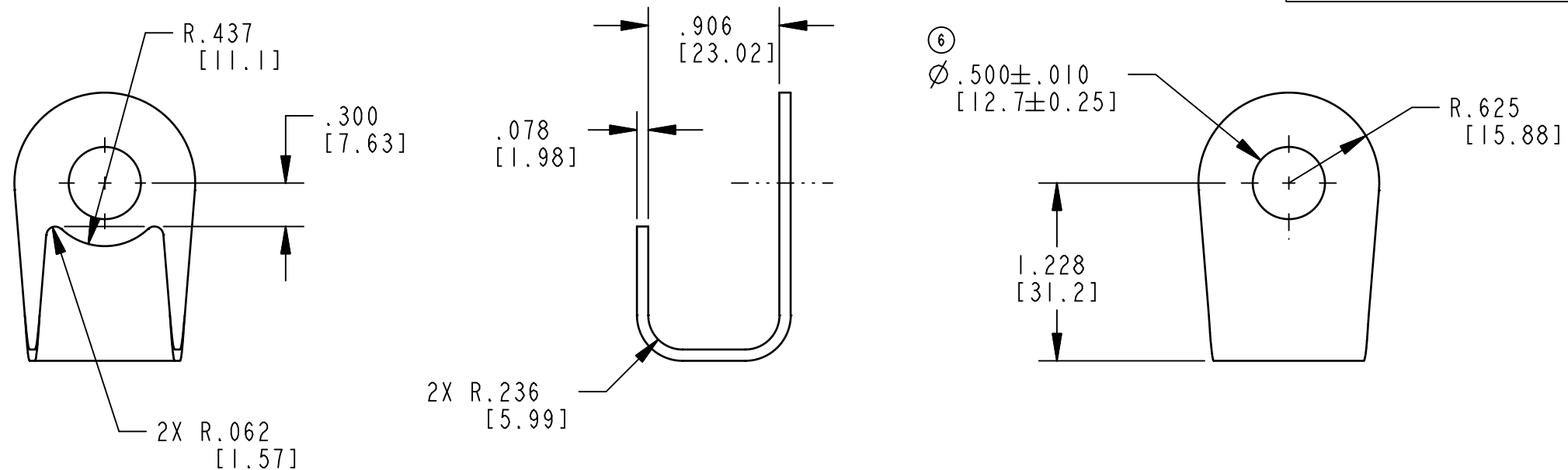

NOTES:

1. DIMENSIONS IN [] ARE MILLIMETERS FOR REFERENCE ONLY.
2. PARTS TO BE ZINC PLATED AND YELLOW CHROMATED PRIOR TO PAINTING.
3. PART TO BE BAGGED AFTER PAINTING AND PLACED IN TRIMARK BOX.

DIMENSIONS	ANGLES
X.X = ±.1	X° = ±1°
X.XX = ±.03	
X.XXX = ±.015	

(5)(7)

81623-16	PLATE, ZINC/COAT, CHROMATE, YELLOW PER ES-104	G03 (030-0200)
81623-12	PAINT, BLACK, MEDIUM GLOSS PER ES-106	G03 (030-0200)
81623-00	NO FINISH	G00 (030-0000)
PART NO.	FINISH	PRODUCT CODE

SPECIFICATION	DESCRIPTION	ITEM	PART NUMBER	DESCRIPTION	QUANTITY
DRAWN BY JPR 12/23/91	CHECKED BY KER 12/24/91	DESIGN ENG. KER 12/24/91	MFG. ENG.	QUALITY ENG.	MATERIAL CRS, 1008/1010 OR 1018
HEAT TREAT					<p>500 Bailey Avenue New Hampton, Iowa 50659 U.S.A. Tel: 641-394-3188 Fax: 641-394-2392</p>
FINISH					
<p>UNLESS OTHERWISE SPECIFIED</p> <p>ASME Y14.5M-1994</p> <p>DIMENSIONS ANGLES</p> <p>X.Y = ±.1 X° = ±1°</p> <p>X.XX = ±.03 X° = ±1°</p> <p>X.XXX = ±.015 X° = ±1°</p>		PROJECT LX91067-1	CUSTOMER JOHN DEERE	CUSTOMER PART NUMBER	
SIZE B	PART WEIGHT	SURFACE AREA	PRODUCT CODE	PART NAME GUARD, STRIKER PIN	
REPORT ERRORS TO ENGINEERING DEPARTMENT			DO NOT SCALE DRAWING		
SCALE FULL		REVISION 7	PART NUMBER 81623-XX		

This drawing and the information contained herein is the property of TriMark Corporation and shall not be used for any purpose without our written consent.