

050-1600
TriGuard Slimline
Heavy Duty Latch



This slimline heavy duty latch module is designed for medium to heavy-duty vehicle entrance and rear door applications. It features a proven single rotor latch design, high strength 8 gauge (4.2mm) front mounting plate and robust straddle mount release lever. The slim design mounts into 2.00" (50.8mm) doors and retrofits competitive single rotor wedge style rotary latches

- Heavy duty entrance door applications for heavy-duty vehicles
- Medium to heavy duty doors of 23-91 kg (50-200 lbs.) with door seal pressures of 23-60 kg (50-150 lbs.)

FEATURES/BENEFITS:

- Heavy duty modular construction — survives in punishing environments
- Can be used on retrofit or new surface mount vehicle construction
- To be used with TriMark's 070-0200 .550 (13.9mm) Diameter Striker Bolt



TriMark Corporation
500 Bailey Avenue
P.O. Box 350
New Hampton, Iowa 50659
United States
Tel: 641-394-3188
Fax: 641-394-2392
1-800-447-0343
www.trimarkcorp.com



TriMark Europe
Cedar Court
Walker Road
Bardon Hill
Coalville LE67 1TU
United Kingdom
Tel: +44(0)1530 512460
Fax: +44(0)1530 512461
www.trimarkeu.com



AVAILABLE:

- Right or left hand configurations (left hand shown)
- Heavy duty latch/striker provides rotor/cam assist to heavy doors, hinges and compensates for door sag
- Replaceable striker alignment lift blocks
- Custom configured release levers

MATERIAL:

- Case halves: High strength steel
- Springs: Non-corrosive stainless steel
- Rotor and catch: Heat treated high strength steel with dry lube coating

FINISH:

- Standard: RoHS compliant zinc plated, clear chromate steel components
- Optional: Powder coated or CARC finish in custom colors

INSTALLATION:

- Three M8 X 1.25 class 8.8 or 5/16-18 UNC Grade 8 or better fasteners are recommended (not included)
- Tighten to the manufacturers' recommended torque value

Individual part dimensions are for reference only. Refer to individual part drawings for complete dimensions, specifications, and installation procedures. Engineering assistance and application drawings are available.

Applications of this latch may fall within the requirements of FMVSS 206 and SAE J839 safety standards. These safety related requirements are dependent on door application, e.g. front and rear hinged doors, sliding doors, or hinged upward swinging doors. The entire door hardware system must be included in the design/analysis process: latch, handle, lock mechanism, rods/linkages, fasteners, hinges, etc. This ensures compatibility of all components within the hardware system. If FMVSS 206 is a requirement, then all of the components within the door system must comply with strength, inertia and locking requirements as specified within the Standard. Note that this product complies with FMVSS 206 when tested with approved TriMark Striker Bolts in accordance with SAE J839 and that this product meets FMVSS 206 load requirements and may be used in FMVSS 206 applications pending TriMark application approval.

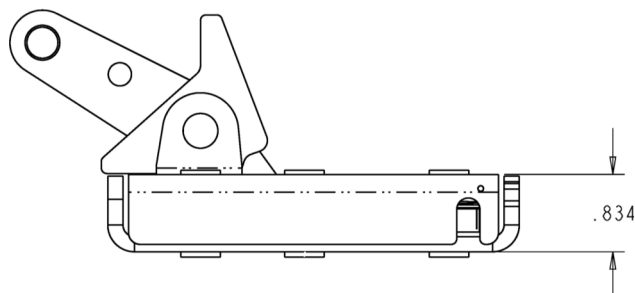
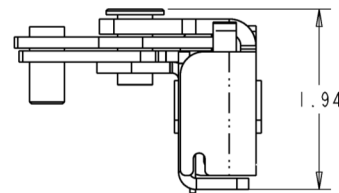
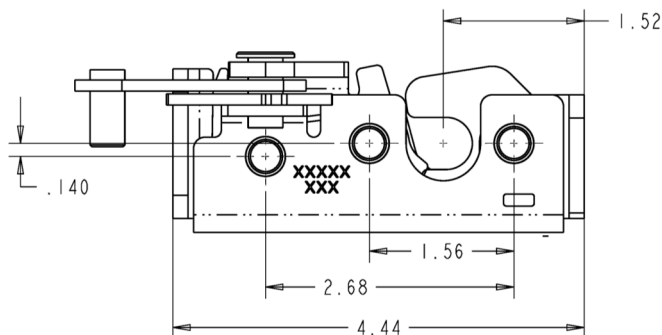
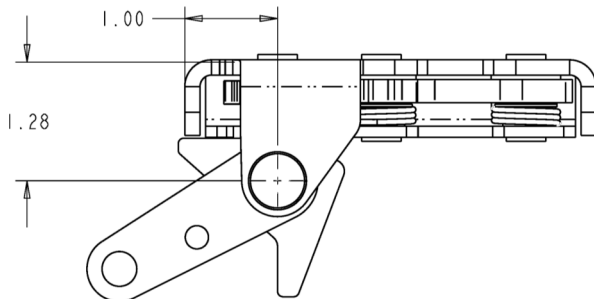

For more information visit
www.trimarkcorp.com